

Addison Instrumentation Tube Fittings

Equal Unions

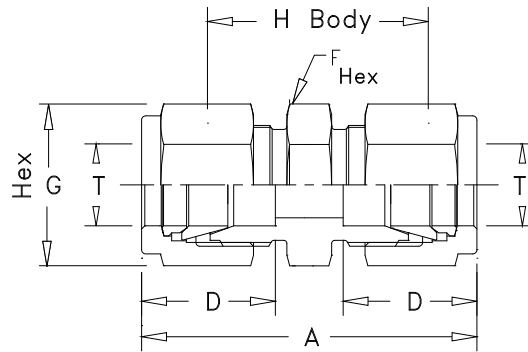

METRIC TUBE		Dimensions in mm				
Part No	T o/d	A	D	F	G Nut	H Body
6mU	6	42.07	15.30	14	14	26.20
8mU	8	44.04	16.20	14	16	28.20
10mU	10	46.04	17.20	18	19	31.00
12mU	12	51.59	22.80	22	22	31.00
16mU	16	52.39	24.40	24	25	31.75
18mU	18	53.98	24.40	27	30	33.34
20mU	20	53.98	26.00	30	32	34.80
25mU	25	64.29	31.30	36	38	40.40

INCH TUBE		Dimensions in inches				
Part No	T o/d	A	D	F	G Nut	H Body
2U	1/8	1.44	0.50	7/16	7/16	0.88
3U	3/16	1.47	0.54	7/16	1/2	0.95
4U	1/4	1.61	0.60	1/2	9/16	1.03
5U	5/16	1.68	0.64	9/16	5/8	1.10
6U	3/8	1.77	0.86	5/8	11/16	1.19
8U	1/2	2.02	0.90	13/16	7/8	1.22
10U	5/8	2.05	0.96	15/16	1	1.25
12U	3/4	2.11	0.96	1-1/16	1-1/8	1.31
16U	1	2.55	1.23	1-3/8	1-1/2	1.59

Reducing Unions

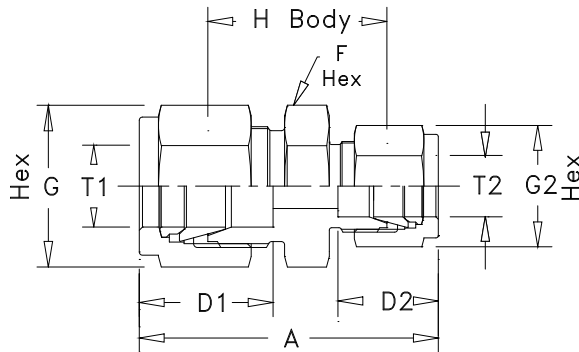

METRIC TUBE		Dimensions in mm							
Part No	T1 o/d	T2 o/d	A	D1	D2	F	G1 Nut	G2 Nut	H Body
8-6mRU	8	6	43.26	16.2	15.3	14	16	14	27.38
10-6mRU	10	6	44.45	17.2	15.3	18	19	14	28.58
10-8mRU	10	8	45.24	17.2	16.2	18	19	16	29.37
12-6mRU	12	6	47.63	22.8	15.3	22	22	14	29.37
12-10mRU	12	10	49.21	22.8	17.2	22	22	19	30.96
16-10mRU	16	10	50.01	24.4	17.2	24	27	19	31.75
16-12mRU	16	12	52.39	24.4	22.8	24	27	22	31.75
20-12mRU	20	12	53.98	26.0	22.8	30	32	22	33.34
20-16mRU	20	16	53.98	26.0	24.4	30	32	27	33.34
25-20mRU	25	20	60.32	31.3	26.0	36	38	32	38.10

INCH TUBE		Dimensions in inches							
Part No	T1 o/d	T2 o/d	A	D1	D2	F	G1 Nut	G2 Nut	H Body
4RU2	1/4	1/8	1.56	0.60	0.50	1/2	9/16	7/16	0.97
4RU3	1/4	3/16	1.55	0.60	0.54	1/2	9/16	1/2	1.00
5RU4	5/16	1/4	1.66	0.64	0.60	9/16	5/8	9/16	1.08
6RU4	3/8	1/4	1.70	0.66	0.60	5/8	11/16	9/16	1.12
6RU5	3/8	5/16	1.74	0.66	0.64	5/8	11/16	5/8	1.16
8RU4	1/2	1/4	1.85	0.90	0.60	13/16	7/8	9/16	1.16
8RU6	1/2	3/8	1.91	0.90	0.66	13/16	7/8	11/16	1.22
10RU6	5/8	3/8	1.94	0.96	0.66	15/16	1	11/16	1.25
10RU8	5/8	1/2	2.05	0.96	0.90	15/16	1	7/8	1.25
12RU 8	3/4	1/2	2.11	0.96	0.90	1-1/16	1-1/8	7/8	1.31
12RU10	3/4	5/8	2.11	0.96	0.96	1-1/16	1-1/8	1	1.31
16RU12	1	3/4	2.47	1.23	0.96	1-3/8	1-1/2	1-1/8	1.59

Dimension are for reference only, and subject to change.